

John Winter

Leading UK
Foundry Supplier



P-type feeder sleeves

A range of highly accurately formed riser sleeves

Our recently improved range of accurately formed blind risers can be inserted as well as mounted on a pattern.

Available in highly exothermic (EXO 28) suitable for high temperature applications such as iron and steel.

Also available as insulating material (ISO 70) and work very well with aluminium and copper-based applications.

See over for details.



**JOHN
WINTER**
WORKING BETTER TOGETHER

EXO 28

A fast-firing, strong exothermic reaction followed by excellent insulating characteristics with a long heat tail. The material is lightweight ($0.5/0.7/\text{cm}^3$) with high insulating capacity.

TYPE	d mm	D mm	a mm	A mm	h mm	H mm	C mm	B mm	Capacity		Modulus	
									dm3	Termik	Geom.	
P355I*	35.50	53.20	30.50	49.50	39.50	49.30	12	2	0.03	0.99	0.60	
P47I	42.00	62.50	35.50	59.50	63.50	73.00	14	2	0.07	1.29	0.78	
P495I	43.00	63.20	36.00	60.50	85.00	97.00	14	2	0.10	1.40	0.85	
P58I	52.50	74.00	48.00	70.20	69.80	79.80	16	2	0.13	1.57	0.95	
P69I	58.00	80.50	52.50	76.25	78.50	92.25	18	2	0.18	1.73	1.05	
P612I	59.25	79.00	50.00	73.50	106.30	115.50	20	2	0.25	1.90	1.15	
P710I	70.00	94.50	65.00	90.25	87.75	99.40	20	2	0.30	1.98	1.24	
P811I	78.50	103.00	71.50	99.75	97.00	107.50	22	2	0.42	2.24	1.40	
P812I*	79.00	102.00	62.00	85.00	112.00	124.00	22	3	0.43	2.26	1.42	
P912I	89.40	116.00	81.00	110.50	103.50	120.00	24	2	0.58	2.50	1.56	
P1013I	97.60	127.90	91.00	120.50	118.75	131.60	26	2	0.80	2.74	1.71	
P1215I*	118.30	155.00	112.00	148.50	130.00	148.50	28	2	1.35	3.25	2.03	
P1415I*	135.00	170.00	125.00	158.00	132.00	153.00	-	-	1.70	3.40	2.12	
P1615I*	160.00	197.50	152.00	184.00	131.00	155.00	-	-	2.50	3.90	2.44	

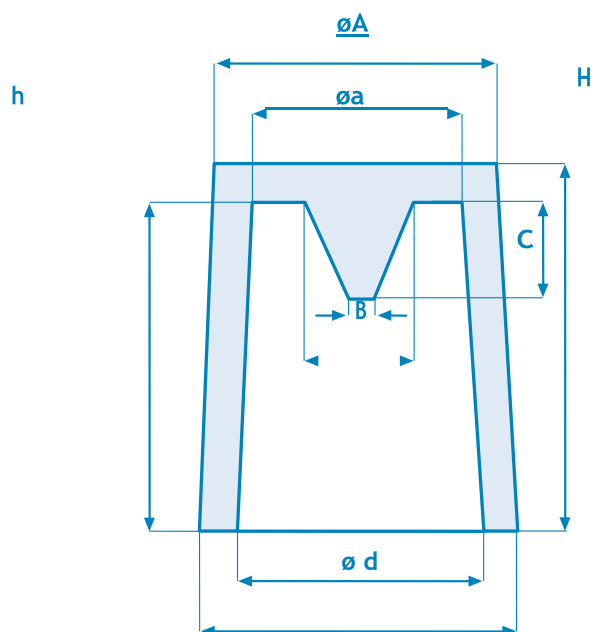

Tolerances	
d	± 1mm
D	± 1 mm
a	± 1 mm
A	± 1mm
h	± 1.5 mm
H	± 1.5 mm
C	± 1 mm
B	± 1 mm

ISOL 70

This grade has high insulating characteristics and is extremely light at $0.3/0.5\text{g/cm}^3$. High dimensional accuracy and strength allows these to be used in automated, manual and inserting applications.

TYPE	d mm	D mm	a mm	A mm	h mm	H mm	C mm	B mm	Capacity	Modulus	
									dm ³	Termik	Geom.
P355I	35.00	53.50	30.50	49.00	39.50	49.00	12	20.03			
P47I	41.00	62.50	35.50	58.50	63.00	73.00	14	20.07	1.10	0.75	
P495I	42.00	63.00	36.00	59.00	85.00	96.00	14	20.10	1.20	0.80	
P58I	51.00	74.00	48.00	69.50	69.50	78.00	16	20.13	1.40	0.95	
P69I	57.50	80.50	52.50	75.50	78.00	90.00	18	20.18	1.50	1.05	
P612I	59.00	79.00	50.00	72.50	106.50	116.00	20	20.25	1.60	1.10	
P710I	69.00	94.50	65.00	89.00	87.00	98.00	20	20.30	1.80	1.25	
P811I	78.50	103.00	71.50	99.00	96.50	106.00	22	20.42	2.05	1.40	
P812I	79.00	102.00	62.00	85.50	112.00	124.00	22	30.43	2.10	1.45	
P912I	89.00	115.00	81.00	109.50	103.50	118.00	24	20.58	2.25	1.55	
P1013I	97.00	127.50	91.00	119.00	117.00	131.00	26	20.80	2.55	1.75	
P1215I	118.00	154.50	112.00	147.00	130.00	150.00	28	21.35	2.90	2.00	

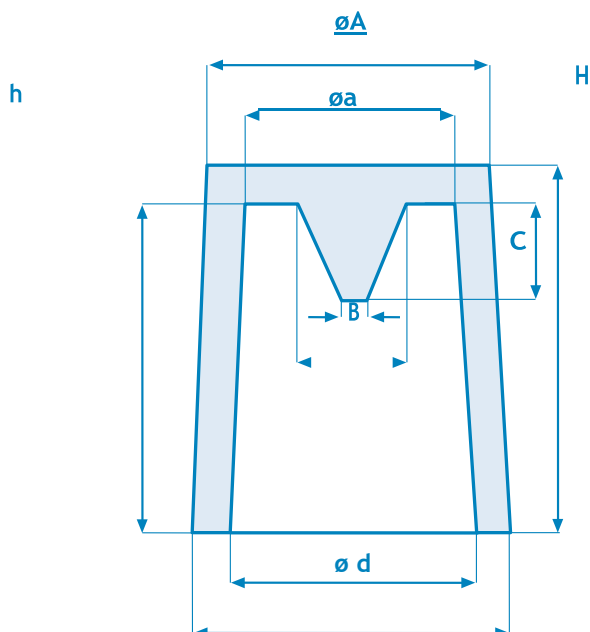

Tolerances	
d	$\pm 1.5\text{mm}$
D	$\pm 1.5\text{ mm}$
a	$\pm 1.5\text{ mm}$
A	$\pm 1.5\text{ mm}$
h	$\pm 2.5\text{ mm}$
H	$\pm 2.5\text{ mm}$
C	$\pm 1.5\text{mm}$
B	$\pm 1\text{ mm}$